

**** WARNING! ****

Circuit Board Must Be Located Correctly with Respect To Wire Colors or This Unit Will NOT Function Correctly!

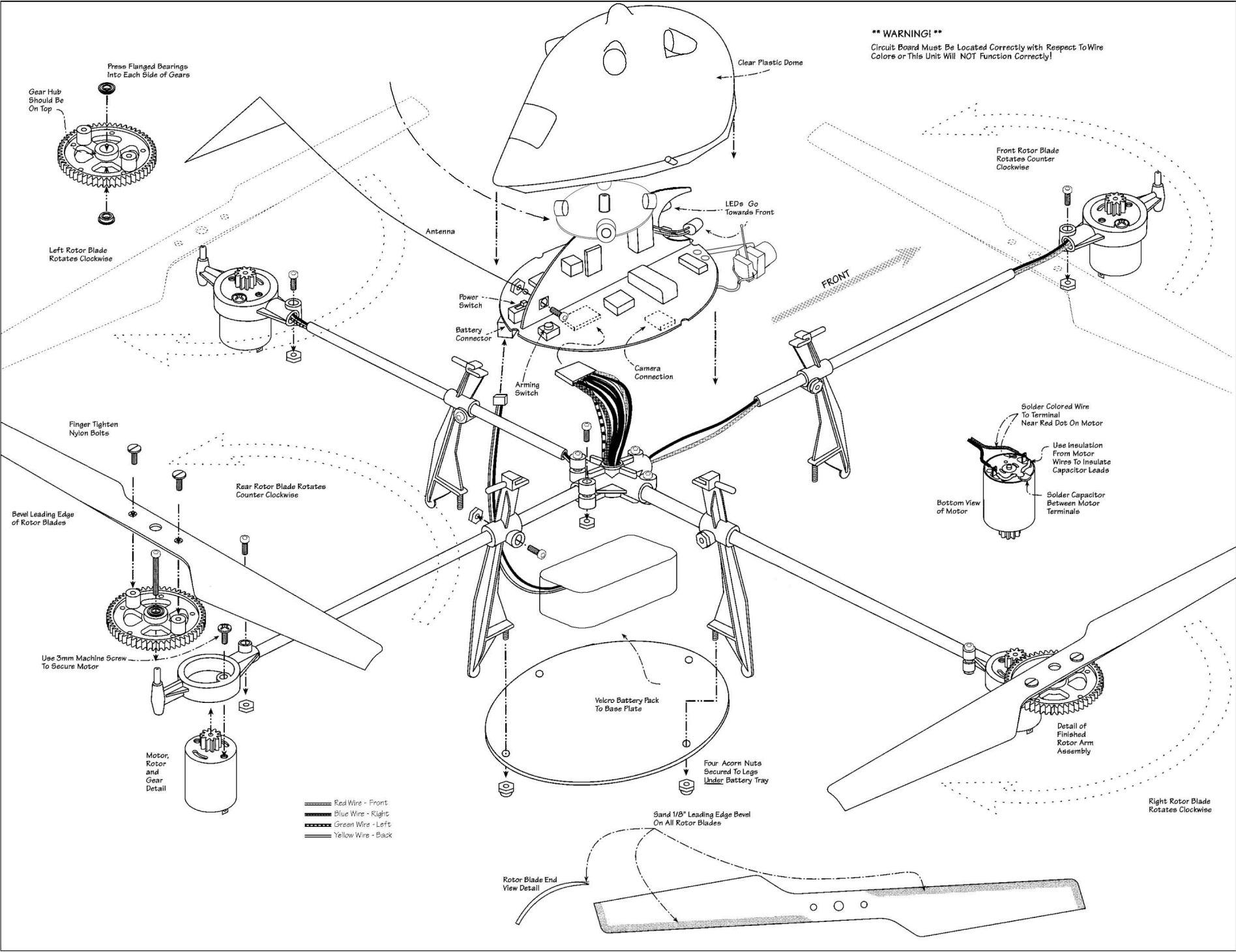

- Red Wire - Front
- Blue Wire - Right
- Green Wire - Left
- Yellow Wire - Back

Rotor Blade End View Detail

Sand 1/8" Leading Edge Bevel On All Rotor Blades

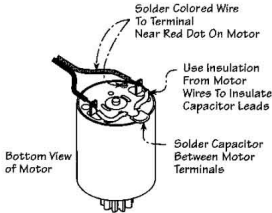
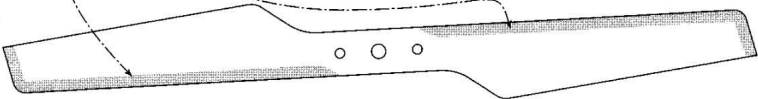

Bottom View of Motor

Solder Colored Wire To Terminal Near Red Dot On Motor

Use Insulation From Motor Wires To Insulate Capacitor Leads

Solder Capacitor Between Motor Terminals

Press Flanged Bearings Into Each Side of Gears

Gear Hub Should Be On Top

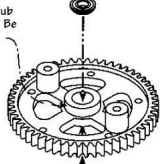

Left Rotor Blade Rotates Clockwise

Finger Tighten Nylon Bolts

Bevel Leading Edge of Rotor Blades

Use 3mm Machine Screw To Secure Motor

Motor, Rotor and Gear Detail

Rear Rotor Blade Rotates Counter Clockwise

Velcro Battery Pack To Base Plate

Four Acorn Nuts Secured To Legs Under Battery Tray

FRONT

Camera Connection

Arming Switch

Battery Connector

Power Switch

Antenna

LEDs Go Towards Front

Clear Plastic Dome

Front Rotor Blade Rotates Counter Clockwise

Detail of Finished Rotor Arm Assembly

Right Rotor Blade Rotates Clockwise